



- 1) All new work shall comply with current California Building Code
- 2) All cross slopes shall be 1.8% or less
- 3) All longitudinal slopes shall be 4.9% or less

## Hagan Community Park Educational Barn Improvements

### Request for Quote --- Plans & Details

Due December 2, 2016

Cordova Recreation & Park District

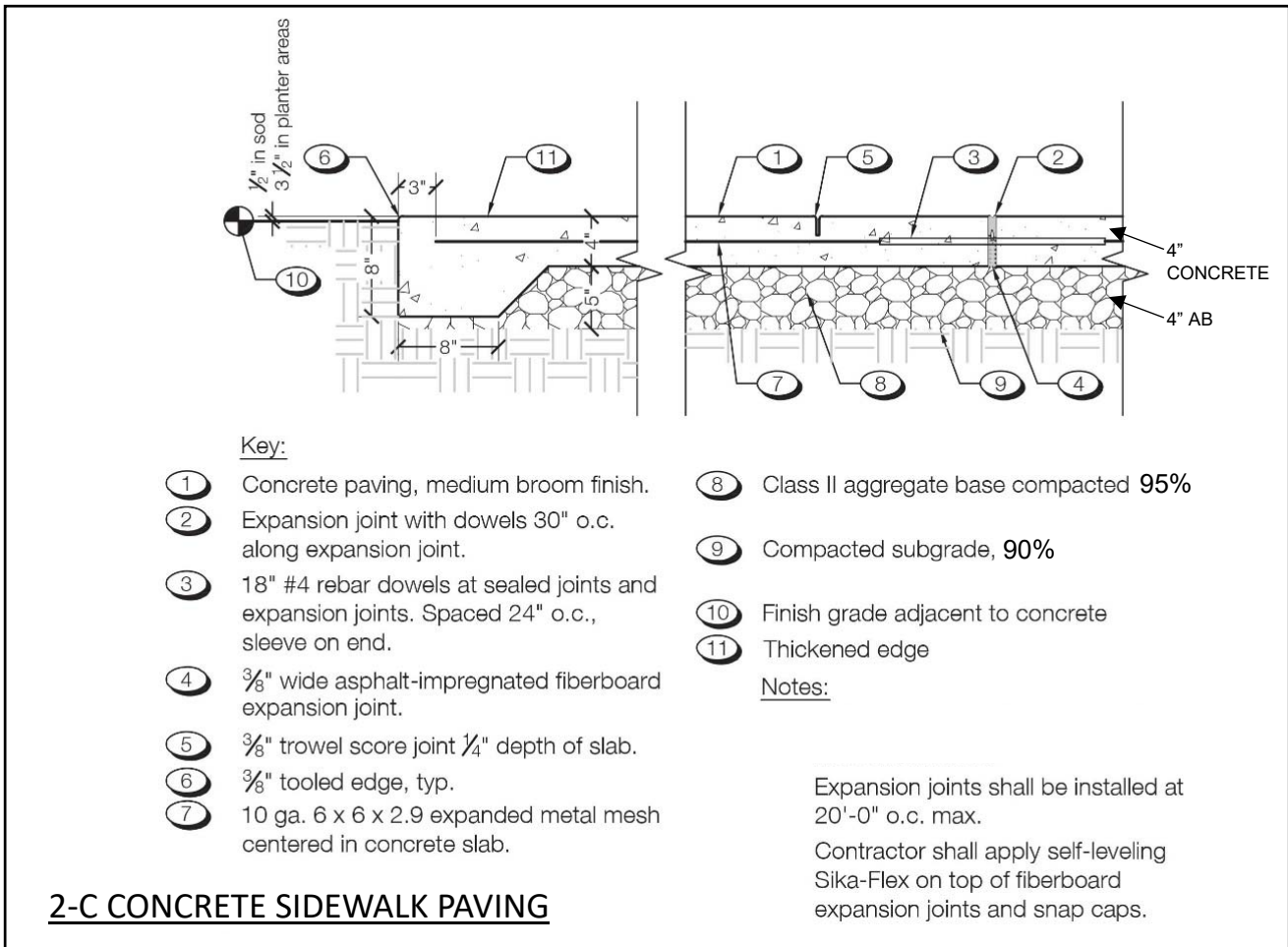
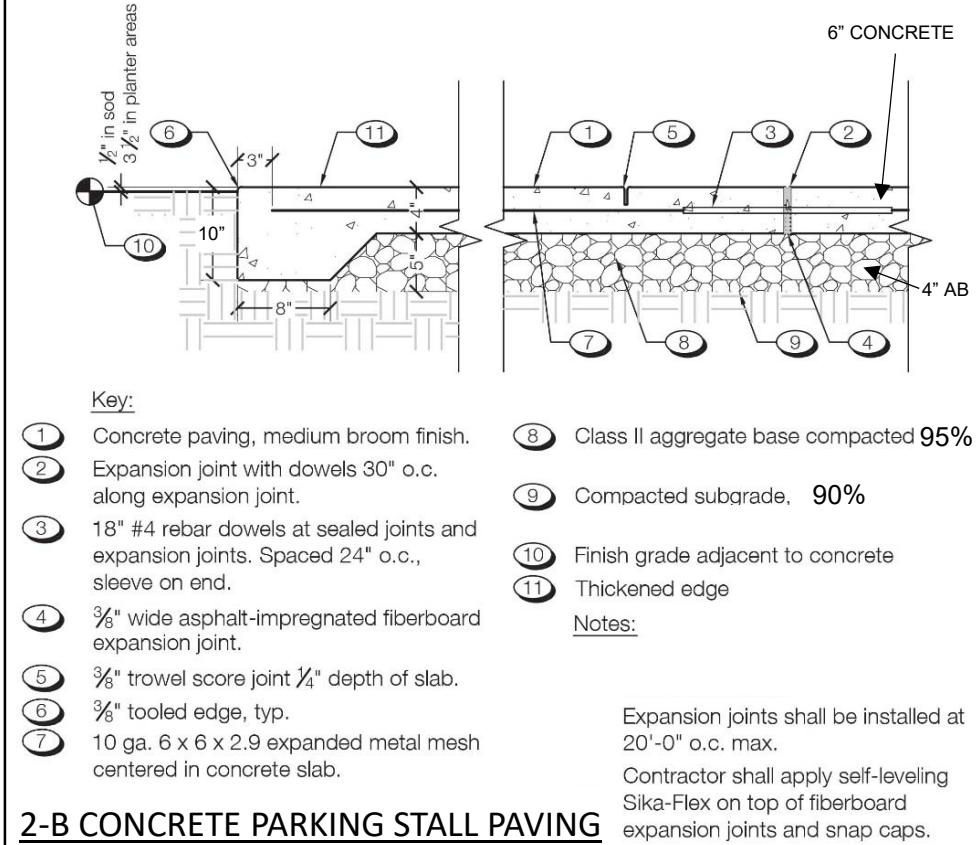
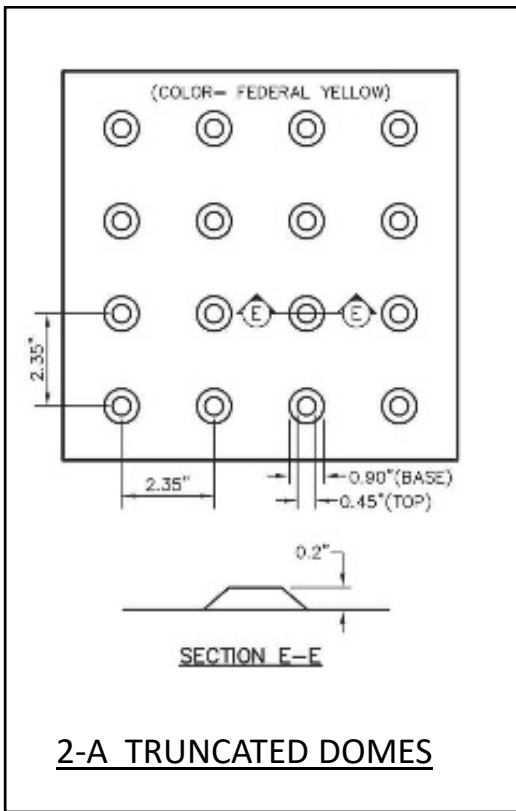

# Hagan Community Park Educational Barn Improvements

## Request for Quote --- Plans & Details

Due December 2, 2016

Cordova Recreation & Park District



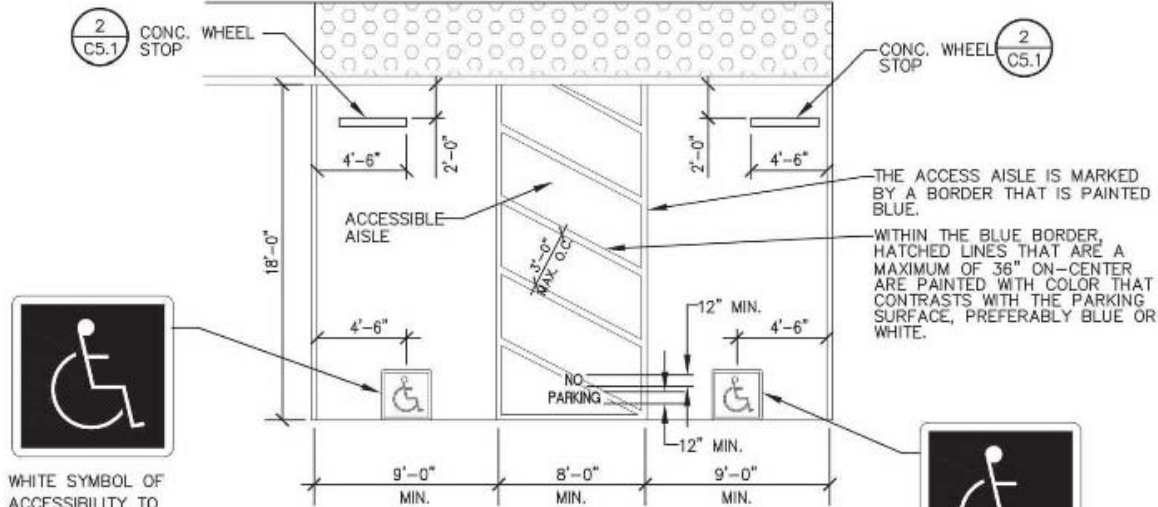

WHITE SYMBOL OF ACCESSIBILITY TO BE 36" HIGH X 36" WIDE ON A BLUE BACKGROUND INTERNATIONAL SYMBOL OF ACCESSIBILITY STALL EMBLEM

**3-A ACCESSIBLE PARKING**  
NO SCALE



WHITE SYMBOL OF ACCESSIBILITY TO BE 36" HIGH X 36" WIDE ON A BLUE BACKGROUND INTERNATIONAL SYMBOL OF ACCESSIBILITY STALL EMBLEM

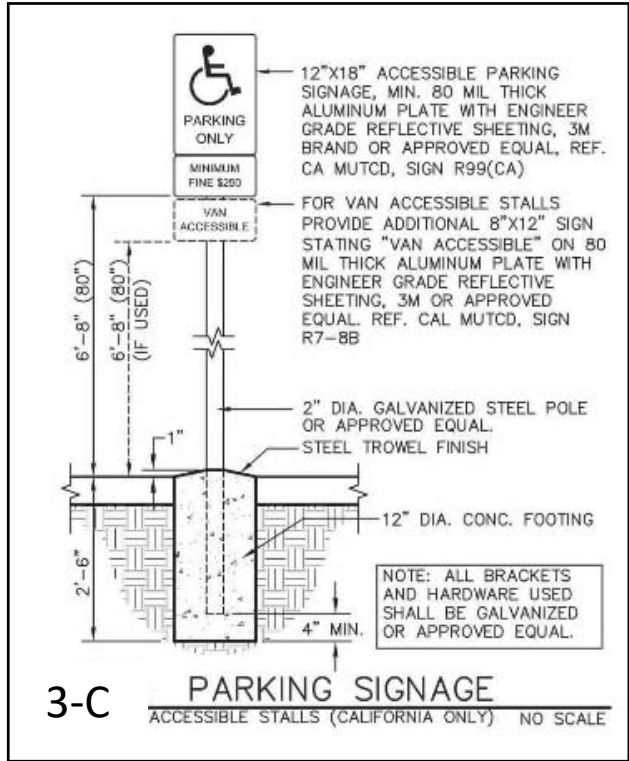

**3-C PARKING SIGNAGE**  
ACCESSIBLE STALLS (CALIFORNIA ONLY) NO SCALE

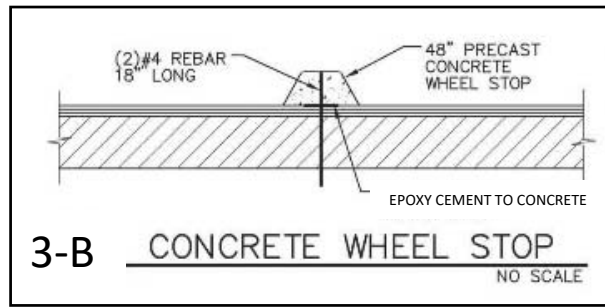

**3-B CONCRETE WHEEL STOP**  
NO SCALE

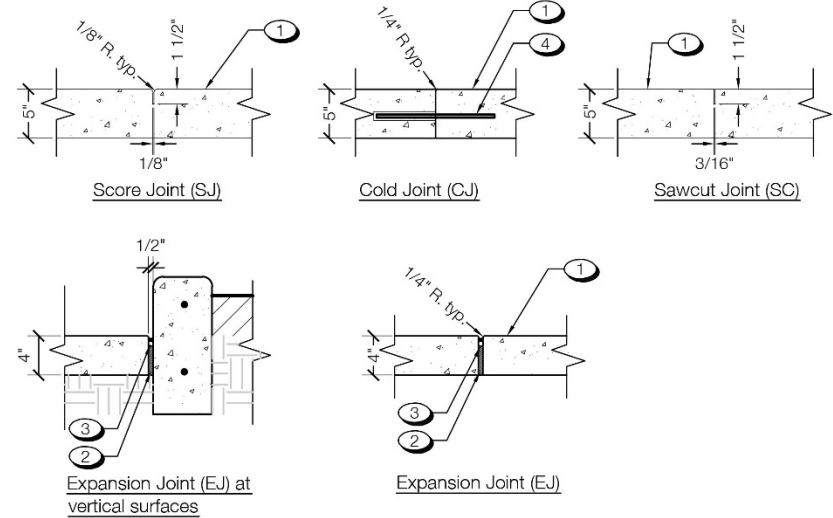

- Key:**
- ① Concrete paving, refer to detail
  - ② Non-extruded, bituminous-type resilient filler
  - ③ Expansion joint filler material with backer rod and sealant.
  - ④ 12" long, #4 smooth dowels at 24" O.C., Locate horizontally in center of slab. Paper wrap one end.

**Notes:**

A. All joints shall be finished with a 1/4" radius edge, typ. unless otherwise noted

**3-D CONCRETE JOINTS**

**Hagan Community Park Educational Barn Improvements**

**Request for Quote --- Plans & Details**

Due December 2, 2016

Cordova Recreation & Park District



Barn Interior



Subpanel Location



Barn Exterior

## Hagan Community Park Educational Barn Improvements

### Request for Quote --- Existing Conditions

Due December 2, 2016

Cordova Recreation & Park District



**Scope of Work:**

- Provide electrical drawings for City permit that comply with Title 24 requirements.
- Provide electrical demolition.
- Upgrade existing subpanel to 60 amp.
- Provide 3 LED fixtures throughout top floor of barn.
- Provide 10 LED fixtures throughout barn (one per stall).
- Provide two additional outlets where shown on plan.

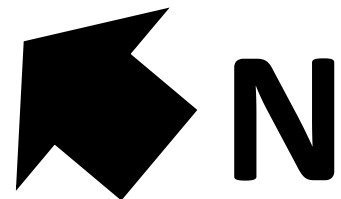
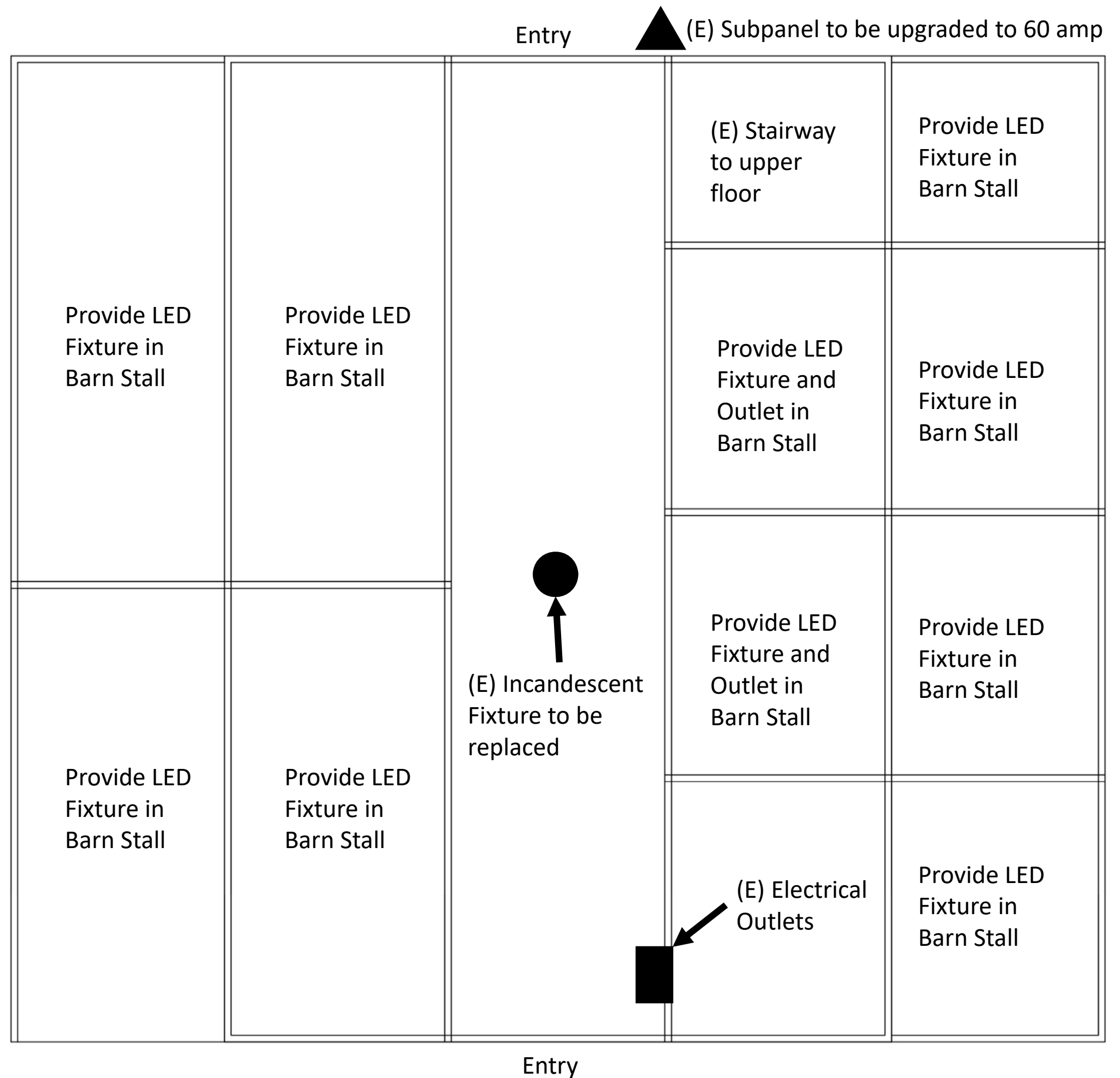

Hagan Red Barn  
ELECTRICAL CONCEPT PLAN

Scale 1/4" = 1'-0"